

COLD STORAGE FACILITY IN JEBEL ALI - MAINLAND

WAREHOUSE **KEY FEATURES**

FACILITY HIGHLIGHTS

- 10,106 Total quantity of pallets.
- 18,280 cbm in total area
- 6,772 sqft of Plant Room.
- Massive corridor and consolidation area.
- Water tank capacity of 135,000 gallons with water pump facility.
- 70 Units of High-Definition Surveillance Cameras, operating 24/7.



FREEZER

- 59,925 sqft or 5,567 sqm of total area.
- Total of 9 Freezer Units of Variable Sizes.
- Room size vary from 154 sqm to 1069 sqm.
- German brand refrigeration system.
- -20° celcius of temperature.
- High-end racking system.

CHILLER

- 8,149 sqft or 757 sqm total area.
- Large Chiller Unit.
- German brand refrigeration system.
- 1° to 5° celcius of temperature.
- High-end racking system.

DRY AREA & STORAGE

- 6,759 sqft or 628 sqm of total area.
- Dry Area & Storage Units of Variable Sizes.
- German brand refrigeration system.
- Ambient temperature of 25° celcius.
- High-end racking system.
- Rooms available with or without temperature control.



OPERATIONS OFFICE & FACILITIES

The ground floor has the significant facilities for the operations such as the administration office for quick processing of logistical documents. Pantries and toilets for both drivers and laborers. And an extra **Store Room** that can be used for various purposes.

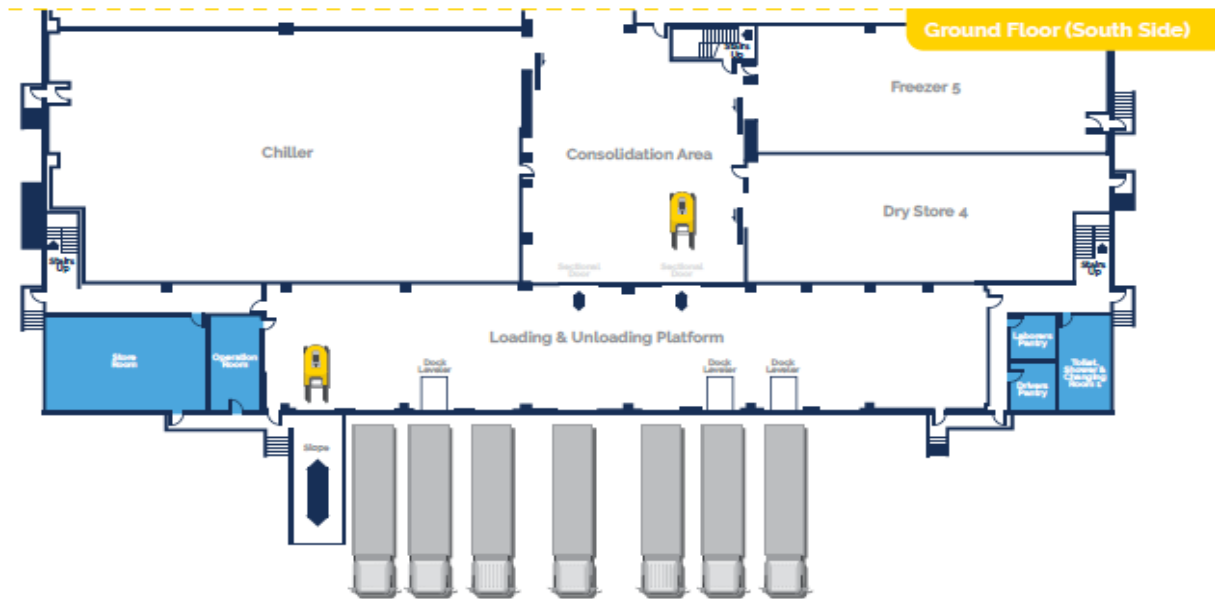

i Floorplans & diagrams does not represent exact measurements.

📍 Both Northeast and Southwest side has gate access to main roads, Emirates Road and Sheikh Mohammad Bin Zayed Road.

MAIN OFFICE

The majority of the offices are situated on mezzanine level, such as the manager's office, 4 office rooms for department divisions, lunch room, pantry, prayer room, ablution and washrooms. These rooms are accessible on staircases both ends of corridor for easy access. All rooms has proper ventilation and airconditioned for comfortable operation.

Unit	Total Area (sqm)	Unit	Total Area (sqm)
Manager & Secretary	75	Lunch Room	134
Office 1	74	Pantry	29
Office 2	75	Washroom	33
Office 3	76	Ablution	25
Office 4	65	Prayer Room	76

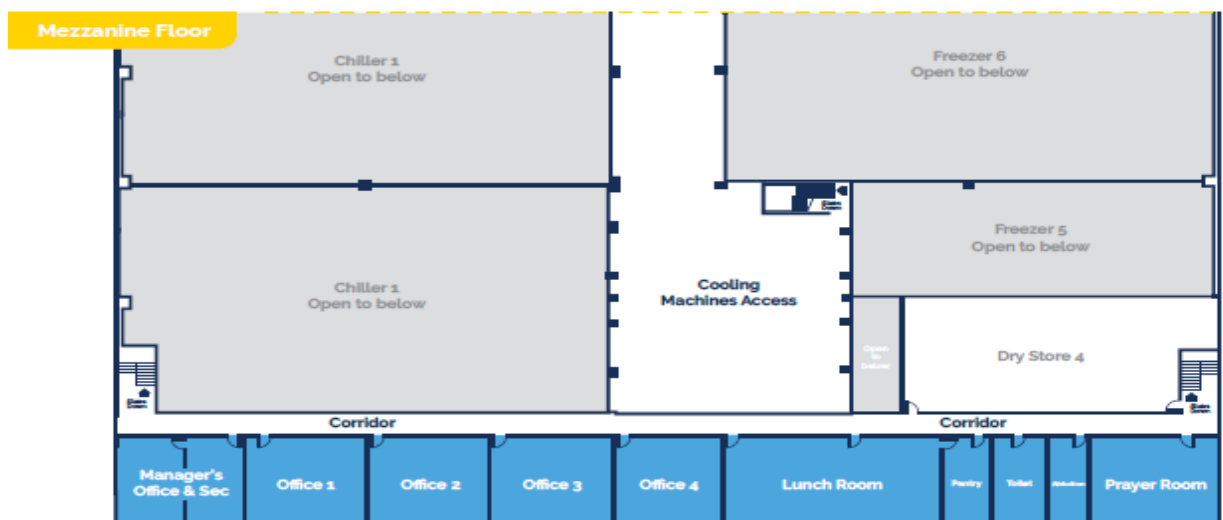

PHOTOS & DOCUMENTATIONS

Loading & Unloading Bay

Receiving area of loading & unloading bay which leads to the consolidation area and corridor. It has quick access to the operation office.



Corridor & Receiving Area

The corridor has a wide space of 7 meters and 10°C temperature.



WAREHOUSE



Typical Coldroom

Built with racking system by Schaefer Systems International.



Articulated Forklifts

Forklifts are articulated which will have easy access on congested spaces.



Chemical Free System

Pathema is used for the water system.



SHARE YOUR INQUIRY

info@agelogistic.com

+971 50 8562165 , +971 54 34 88778